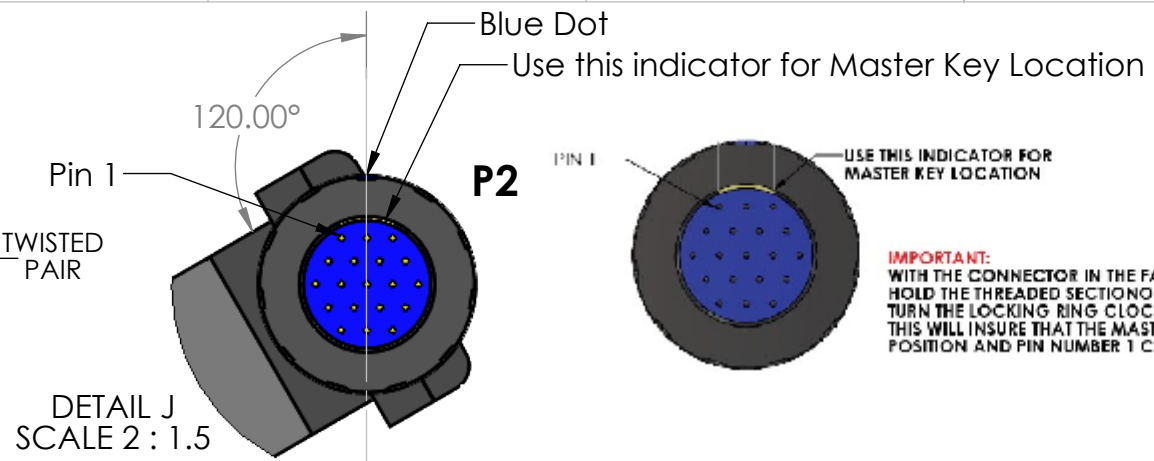
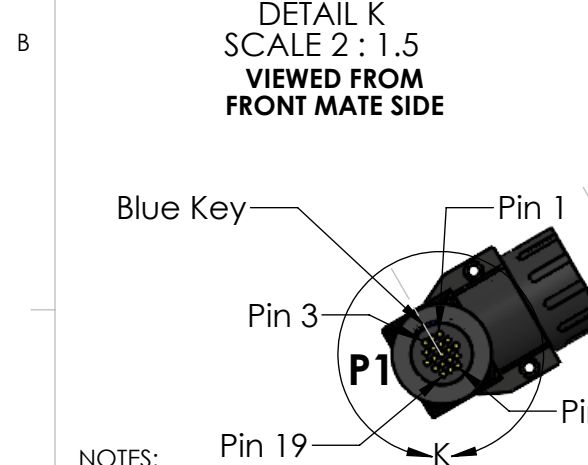
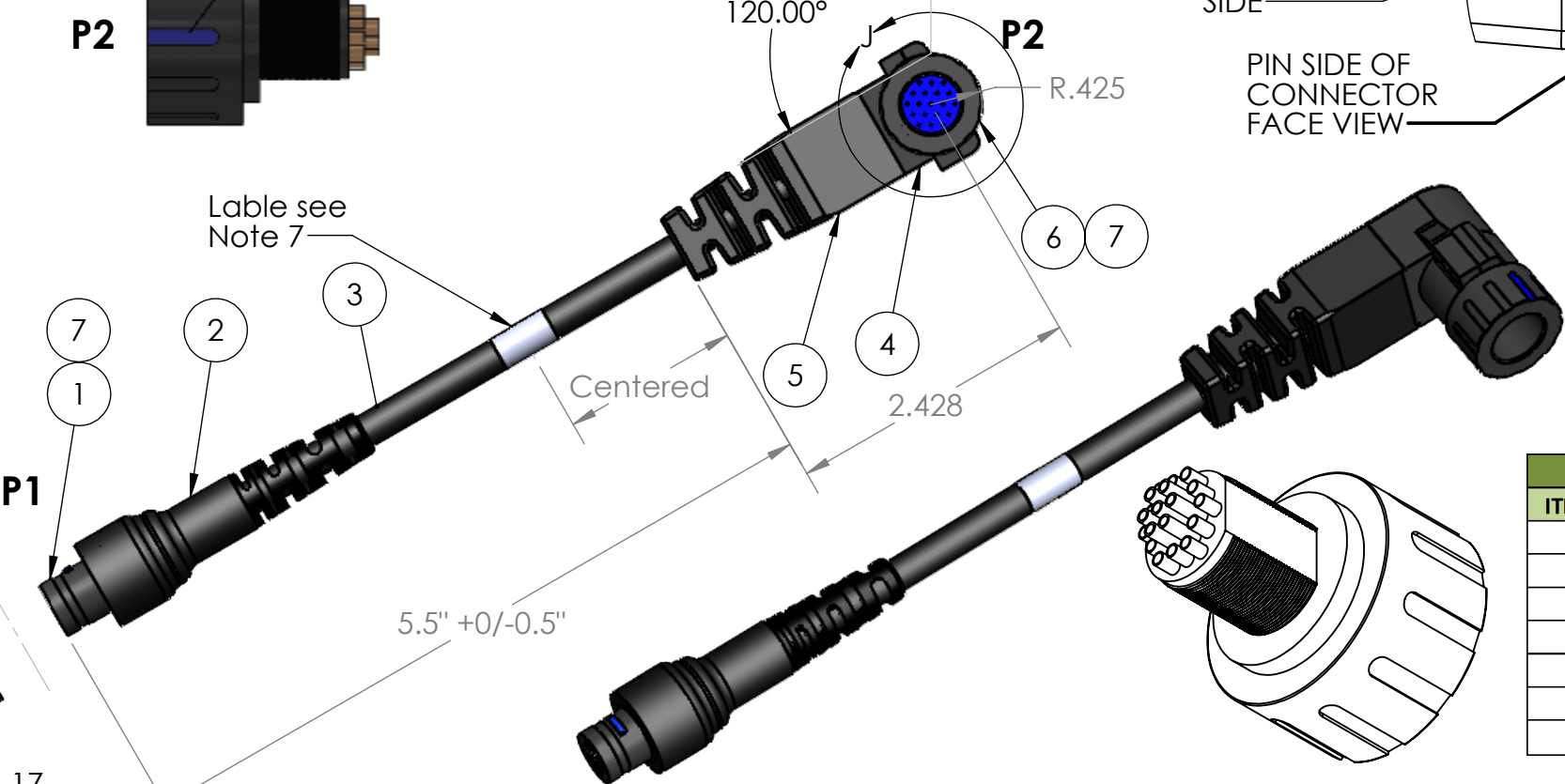
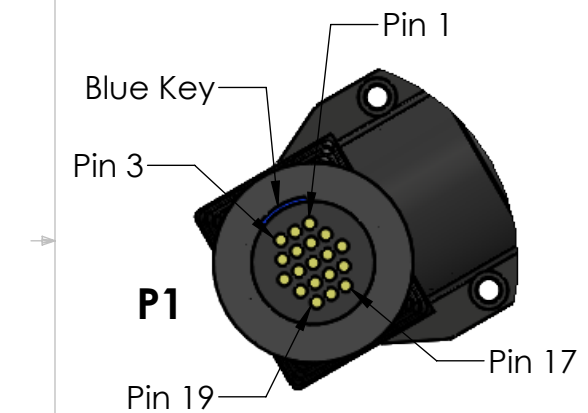
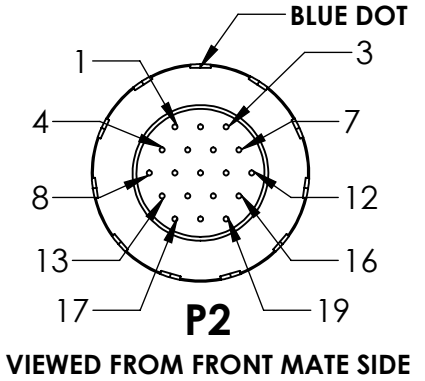
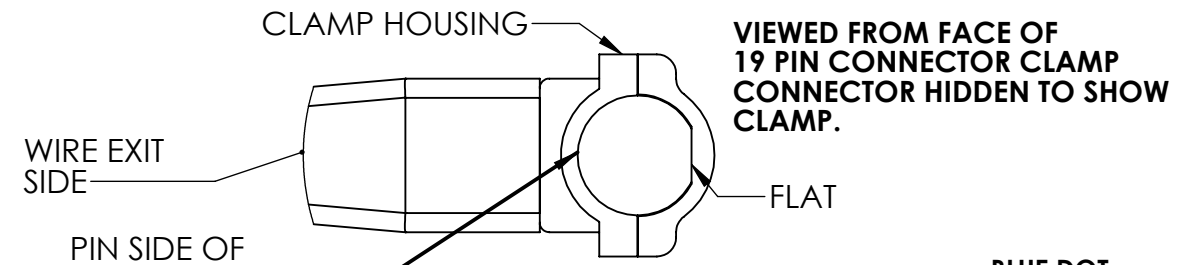
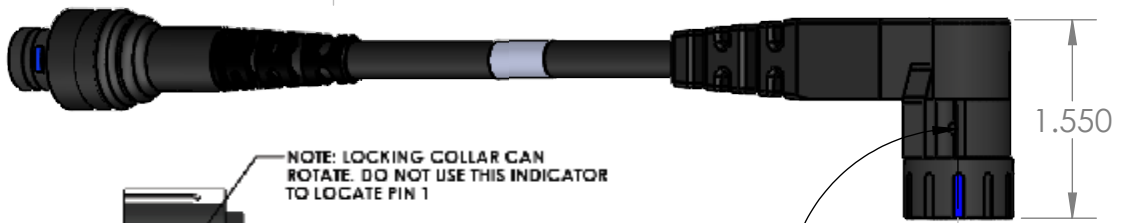

TABLE 1: WIRE RUN LIST		
P1	WIRE COLOR	P2
1	BLACK	1
2	DARK GREEN	2
3	DARK ORANGE**	3
4	YELLOW	4
5	LIGHT GREEN*	5
6	BLUE	6
7	CLEAR	7
8	VIOLET	8
9	GRAY	9
10	DARK BLUE**	10
11	TAN	11
12	LIGHT BLUE*	12
13	CLEAR	13
14	PINK	14
15	BROWN	15
16	RED	16
17	ORANGE	17
18	WHITE	18
19	GREEN	19
SHELL	SHIELD	SHELL



REV	DATE	DESCRIPTION OF CHANGE	ENG
1	7/8/21	UNDER CUSTOMER REVIEW	RAM
2	7/26/21	Updated Ref Number call out & Label	RAM
3	8/12/21	ADDED WIRE COLORS & TWISTED PAIR NOTES	MOB
4	9-9-21	Added View J	RAM
5	9-13-21	Updated	RAM
6	9-13-21	Corrected P1 pinout for Pass Through	RAM
7	9-13-21	P2 Key Location for Pin 1 position, Diagram	RAM
8	9-21-21	Added Sheet 2 for Item #1	RAM



BILL OF MATERIALS			
ITEM NO.	PART NUMBER	QTY	NAME
1	078426-0000	1	19 PIN CIRCULAR CONN. Female
2	TBD	1	OVERMOLD FOR 078426-0000
3	51234	1	19C AWG 26 .270 OD CABLE
4	SN-448-7873-007R	1	90 DEGREE ELBLOW
5	TBD	1	OVERMOLD FOR 078379-6100
6	078379-6100	1	19 PIN CIRCULAR CONN. Male
7	BE-04 OR EQU.	2	BANDING CLAMP

- NOTES:
- CABLE 2: 26 AWG, 19 CONDUCTOR, OD: 0.270 NOMINAL. POLYURETHANE INSULATION. OUTER SHIELD 38 AWG, TIN PLATED COPPER BRAID, 90% COVERAGE.
  - OVERMOLD MATERIAL: 90A POLYETHER-TYPE THERMOPLASTIC POLYURETHANE (TPU).
  - JACKET: BLACK MATTE FINISH.
  - SOLDERING IAW IPC-J-STD-001 AS APPLICABLE.
  - CABLE ASSEMBLIES TO BE 100% TESTED FOR CONTINUITY, SHORTS AND INSULATION RESISTANCE (250V @100MOHM MINIMUM)
  - CAP AND STOW UNUSED WIRES. PLACE SHRINK BOOT OVER DRAIN WIRE.
  - PLACE IN A ZIPLOCK BAG, CABLE TO HAVE WHITE LABEL WITH BLACK LETTERS, LABEL TO READ:  
PN: SN-FALCON4-ADF-C1 REV. X (REV X PER P.O.)  
CAGE CODE: 1HJX9  
DATE OF MFG: MM/YY

UNLESS OTHERWISE SPECIFIED:  
 DIMENSIONS ARE IN: INCHES  
 TOLERANCES: .XX: ± 0.03  
 .XXX: ± 0.005  
 ANGULAR: .X°: 1°  
 .XX°: 0.5°  
 BREAK EDGES: .005 - .020  
 FILLETS: .005 - .020  
 SURFACE FINISH:  
 GEOMETRIC TOLERANCING PER: ASME Y14.5-2009  
 MATERIAL: SEE DRAWING NOTES  
 FINISH: SEE DRAWING NOTES  
 DO NOT SCALE DRAWING

NAME	DATE
DRAWN: RAM	7/8/21
CHECKED: RB	7/8/21
COMMENTS:	

REF NUMBER: SN0841

**SupplyNet** 706 EXECUTIVE BLVD. SUITE B VALLEY COTTAGE NY 10989

TITLE: **CABLE ASSEMBLY Right Angle ADF Straight Through**

SIZE **B** DWG. NO. **SN-FALCON4-ADF-C1** REV **8**

CAGE CODE: 1HJX9 SCALE: NA WEIGHT: SHEET 1 OF 2

DOCUMENT IS COMMERCIAL AND SUBJECT TO EXPORT CONTROL.

REV	DATE	DESCRIPTION OF CHANGE	ENG
8	9/21/21	Added Sheet 2 for Item #1	RAM

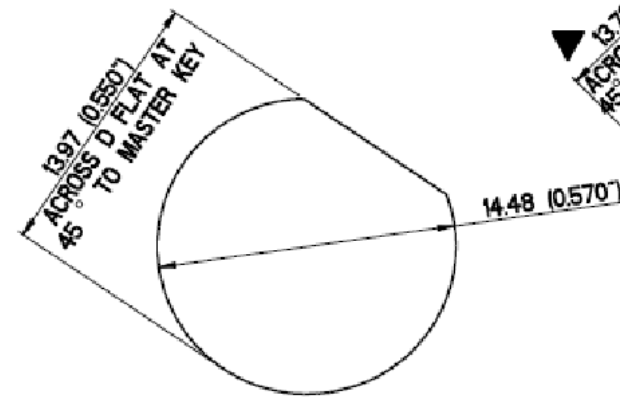
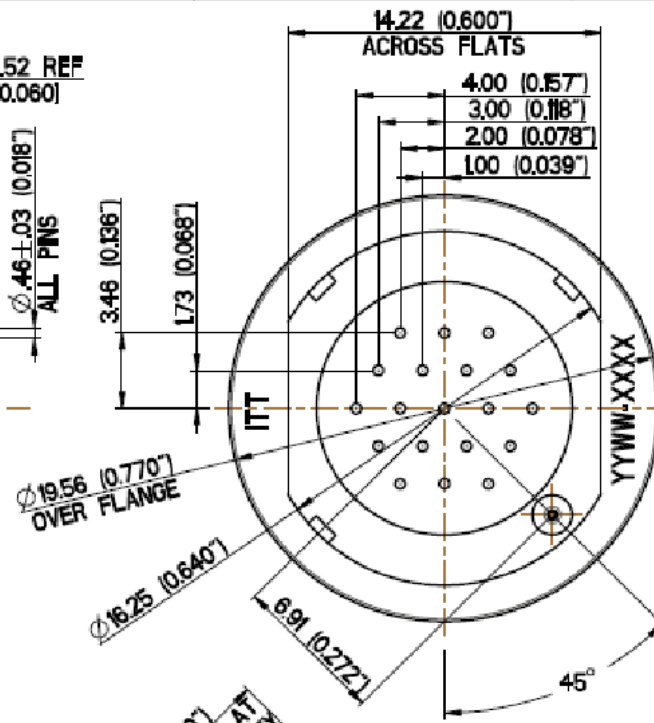
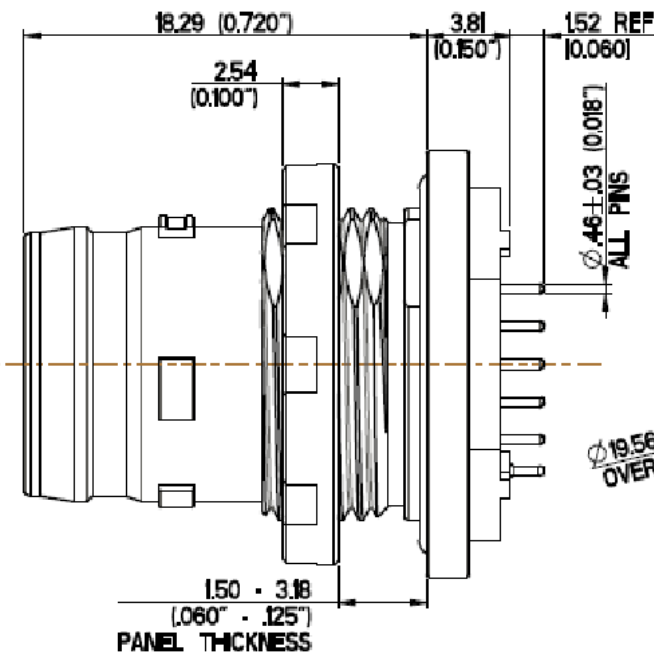
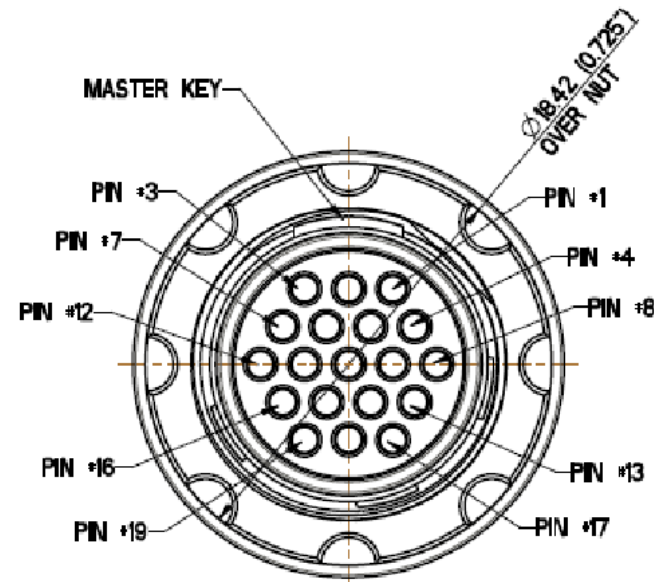

PANEL CUTOUT DETAIL  
NOT TO SCALE

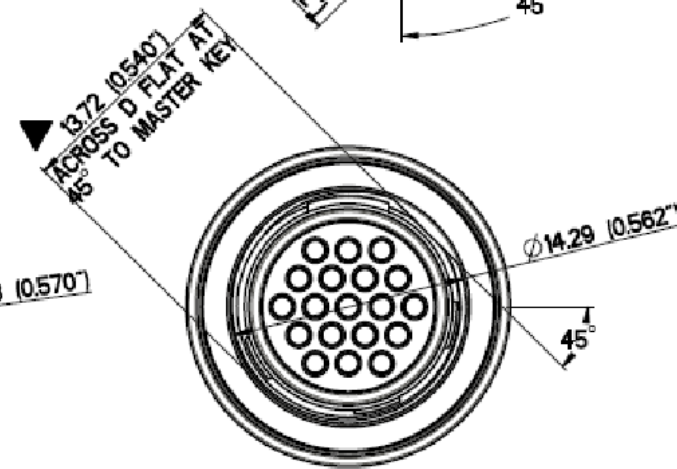

DIMENSIONS FOR PANEL MOUNTING  
WITH JAM NUT REMOVED  
SCALE 3:1

- NOTE**
- DIMENSIONS ARE NOMINAL UNLESS STATED OTHERWISE.
  - MATERIALS / FINISH :-  
 BODY PARTS.....ST. STEEL.....BLACK ELECTROLESS NICKEL  
 INSULATORS.....HIGH TEMPERATURE THERMOPLASTIC.  
 CONTACTS.....COPPER ALLOY.....GOLD.  
 O RING.....FLUOROSILICONE RUBBER
  - FOR KEYING OPTIONS SEE SHEET 2
  - TO SUIT 0.062" THICK PCB.
  - ELECTRICAL RATING 50 VDC, 2A CONTINUOUS, 3A PEAK (LIMITED BY MATING HALF).  
 IR > 5000 Mohms ( > 1000 Mohm after immersion) 100 vdc  
 DWV > 500v
  - OPERATING TEMPERATURE -55°C TO +125°C
  - NOMENCLATURE NEMHMDC719PPNT-B2-002
  - RECEPTACLE SUITABLE FOR TERMINATION TO STANDARD (NEMHMSB) AND DUAL COUPLING (NEM\_DC) PLUGS.
  - CONNECTOR SUITABLE FOR IP68 IMMERSION, 20m FOR 2 HOURS.
  - ▼ DENOTES CRITICAL INSPECTION FEATURE.

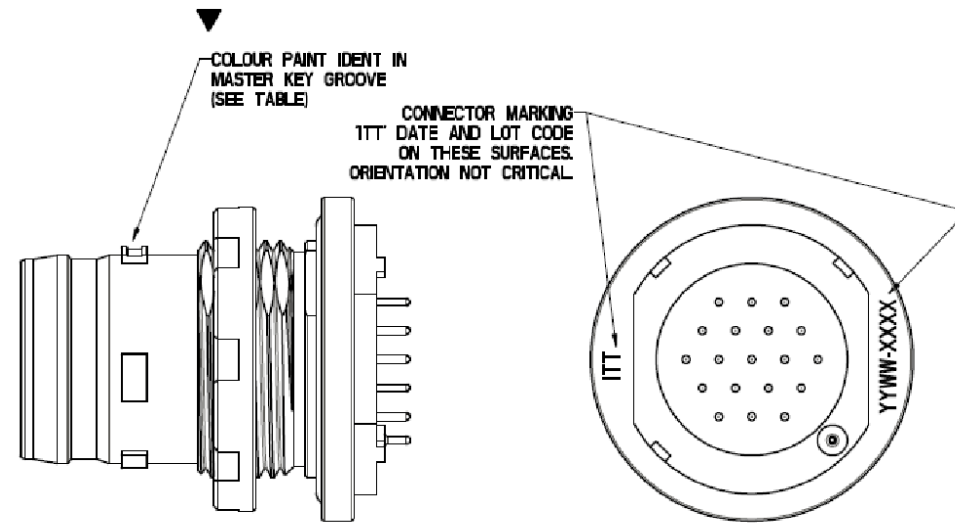
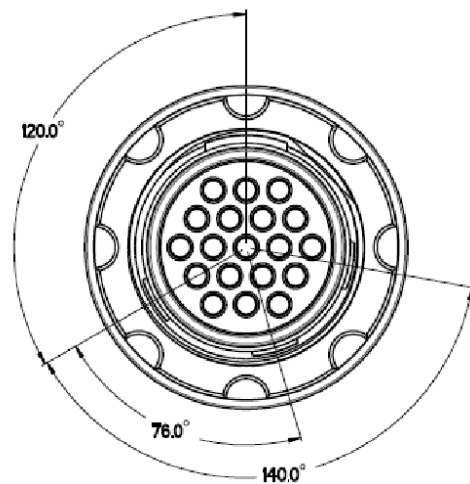

SEE NOTE 10.

DESCRIPTION	ITT PART NUMBER	CODE REF	∠ P	COLOUR
NEMHMDC719PPNT-B2-002	078426-0000	N	120°	D. BLUE
NEMHMDC719PPAT-B2-002	078426-0001	A	132°	RED
NEMHMDC719PPBT-B2-002	078426-0002	B	108°	GREEN
NEMHMDC719PPCT-B2-002	078426-0003	C	96°	GREY
NEMHMDC719PPDT-B2-002	078426-0004	D	84°	YELLOW

UNLESS OTHERWISE SPECIFIED:  
 DIMENSIONS ARE IN: INCHES  
 TOLERANCES: .XX: ± 0.03  
 .XXX: ± 0.005  
 ANGULAR: .X°: 1°  
 .XX°: 0.5°  
 BREAK EDGES: .005 - .020  
 FILLETS: .005 - .020  
 SURFACE FINISH:  
 GEOMETRIC TOLERANCING PER: ASME Y14.5-2009  
 MATERIAL: SEE DRAWING NOTES  
 FINISH: SEE DRAWING NOTES  
 DO NOT SCALE DRAWING

NAME: RAM  
 DATE: 7/8/21  
 DRAWN: RB  
 CHECKED: RB  
 7/8/21  
 COMMENTS:  
 PROPRIETARY AND CONFIDENTIAL  
 THE INFORMATION CONTAINED IN THIS DRAWING IS THE SOLE PROPERTY OF SUPPLYNET, INC. ANY REPRODUCTION IN PART OR AS A WHOLE WITHOUT THE WRITTEN PERMISSION OF SUPPLYNET INC. IS PROHIBITED.

**SupplyNet** 706 EXECUTIVE BLVD. SUITE B VALLEY COTTAGE, NY 10989

TITLE: **CABLE ASSEMBLY Right Angle ADF Straight Through**

SIZE: **B** DWG. NO.: **SN-FALCON4-ADF-C1** REV: **8**

SCALE: NA WEIGHT: SHEET 2 OF 2

**This Sheet is for Item #1 only.**  
 All notes, dimensions and info apply only to Item #1.  
 P/N 078426-0000