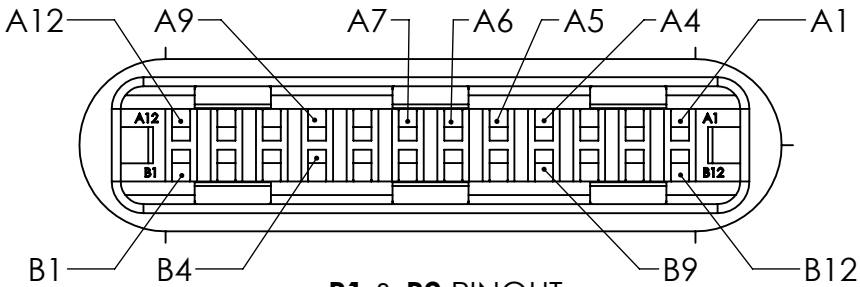

TABLE 1: WIRE RUN		
P1	WIRE COLOR	SIGNAL
A1, A12, B1, B12	BLACK	GND
A4, A9, B4, B9	RED	VBUS
A6	GREEN	USB 2.0 D+
A7	WHITE	USB 2.0 D-
A5	BLUE	CC1
B5	BROWN	CC2/VCONN
SHELL	SHIELD	CHASSIS GND

\*SEE SHEET 2 FOR P1 & P2 PCB PINOUT



P1 & P2 PINOUT  
(MATING FACE VIEW)

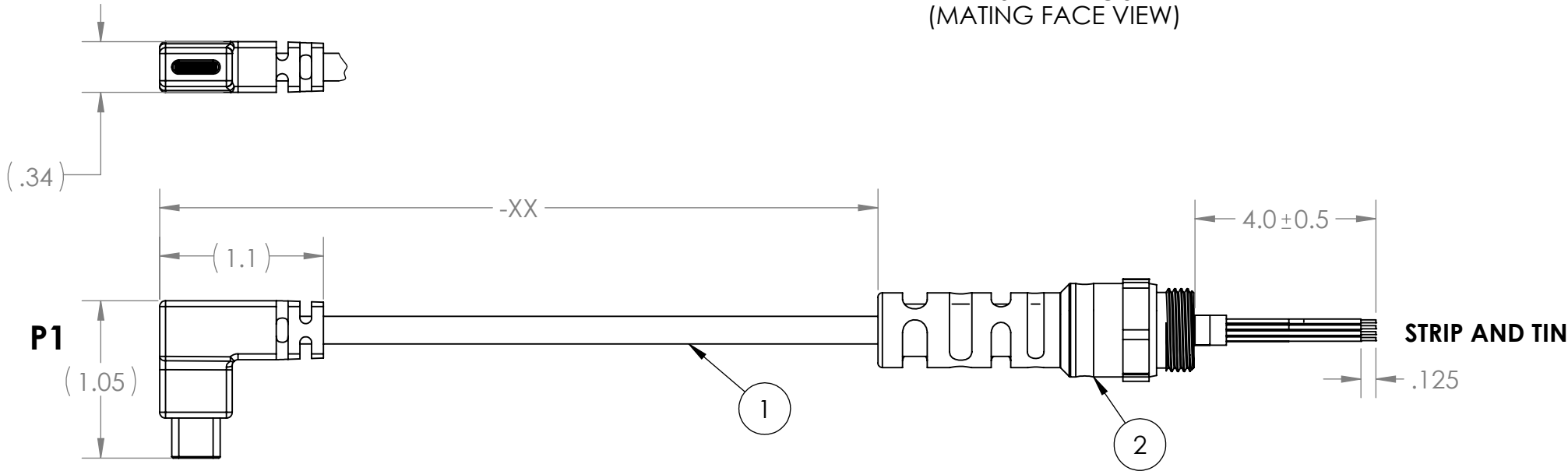
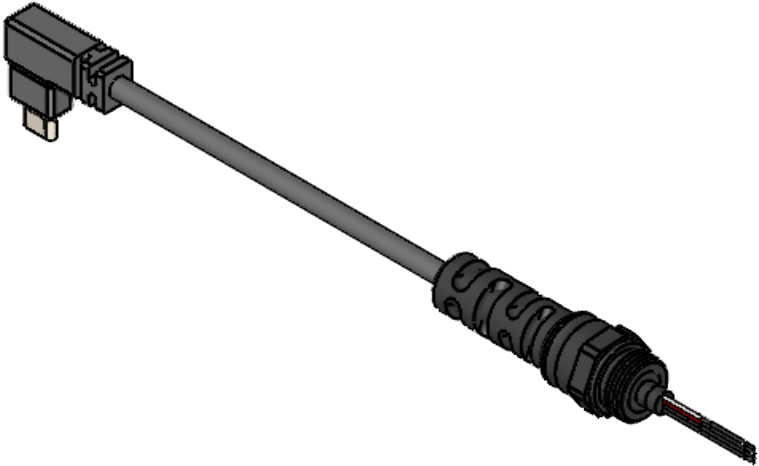

TABLE 2: CABLE LENGTH TABLE		
"-XX"	LENGTH (IN)	TOL
-01	12.0	+/- 0.5
-03	36.0	+/- 1.0
-06	72.0	+/- 3.0

BILL OF MATERIALS			
ITEM NO.	PART NO.	QTY	NAME/DESCRIPTION
1	SN-2013-PD-XX	1	DOUBLE ENDED USB-C RT ANGLE, USB-C PD CAPABLE
	594	1	USB 3.1 TYPE C MALE WITH BREAKOUT PCB, ALL PINS AVAILABLE
	SN-OM-2013	1	USB TYPE C OVER-MOLD
	BN226422FEPSSIL	-XX	USB CABLE: 22/28 AWG, 6C, SHIELDED, .185 DIA.
2	YS32-0206/YS32-0207	1	9/16-24 THREADED OVER MOLD

- NOTES:
- WIRING SHALL BE DONE IN ACCORDANCE WITH TABLE 1 WIRE RUN LIST.
  - SOLDERING: IAW IPC-J-STD-001 CLASS 2 AS APPLICABLE
  - ASSEMBLY TO BE 100% TESTED FOR SHORTS, CONTINUITY, AND JACKET RESISTANCE (250V @ 100MOHM MIN.)
  - IDENTIFICATION: BAG AND IDENTIFY ON THE PACKAGING THE FOLLOWING INFORMATION FOR EACH PART DELIVERED.  
PN: SN-2013-PD-916-XX REV. X (REV MARKING PER PO)  
CAGE CODE: 1HJX9  
MFD: MM/YY
  - MANUFACTURE AND INSPECT IAW IPC/WHMA A-620 CLASS 2.

UNLESS OTHERWISE SPECIFIED:		NAME	DATE	<div>SupplyNet</div>		706 EXECUTIVE BLVD SUITE B VALLEY COTTAGE, NY 10989			
DIMENSIONS ARE IN: INCHES		DRAWN	MOB	10/31/22	TITLE:  <b>CABLE, USB-C RT ANGLE, 9/16-24 THREADED SR, USB- C PD CAPABLE</b>				
TOLERANCES: .XX: ± 0.03 .XXX: ± 0.005		CHECKED	RB	10/31/22					
ANGULAR: .X°: 1° .XX°: 0.5°		COMMENTS:							
BREAK EDGES: .005 - .020									
FILLETS: .005 - .020									
SUFACE FINISH:		<b><u>PROPRIETARY AND CONFIDENTIAL</u></b> THE INFORMATION CONTAINED IN THIS DRAWING IS THE SOLE PROPERTY OF SUPPLYNET, INC. ANY REPRODUCTION IN PART OR AS A WHOLE WITHOUT THE WRITTEN PERMISSION OF SUPPLYNET INC. IS PROHIBITED.							
GEOMETRIC TOLERANCING PER: ASME Y14.5 -2009		SIZE			DWG. NO.		REV		
MATERIAL: SEE DRAWING NOTES		<b>B</b>			<b>SN-2013-PD-916-XX</b>		<b>A</b>		
FINISH: SEE DRAWING NOTES		DO NOT SCALE DRAWING			<b>CAGE CODE: 1HJX9</b>		SCALE: NA	WEIGHT:	SHEET 1 OF 2

REF. NUMBER: SN0938

**SupplyNet** 706 EXECUTIVE BLVD  
SUITE B  
VALLEY COTTAGE, NY 10989

TITLE:  
**CABLE, USB-C RT ANGLE,  
9/16-24 THREADED SR, USB-  
C PD CAPABLE**

SIZE	DWG. NO.	REV
<b>B</b>	<b>SN-2013-PD-916-XX</b>	<b>A</b>

# DRAWING FOR SUB-ASSEMBLY ITEM NO. 1

TABLE 1: WIRE RUN			
P1	WIRE COLOR	P2	SIGNAL
A1, A12, B1, B12	BLACK	A1, A12, B1, B12	GND
A4, A9, B4, B9	RED	A4, A9, B4, B9	VBUS
A6	GREEN	A6	USB 2.0 D+
A7	WHITE	A7	USB 2.0 D-
A5	BLUE	A5	CC1
B5	BROWN	B5	CC2/VCONN
SHELL	SHIELD	SHELL	CHASSIS GND

\*SEE SHEET 2 FOR P1 & P2 PCB PINOUT

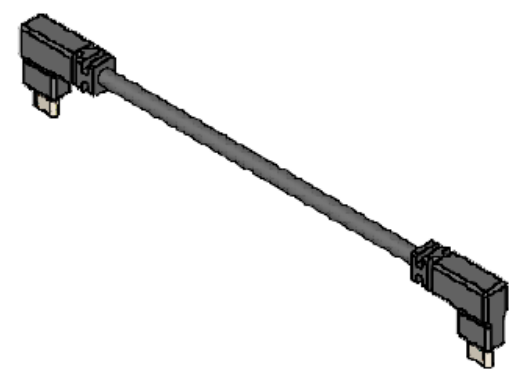
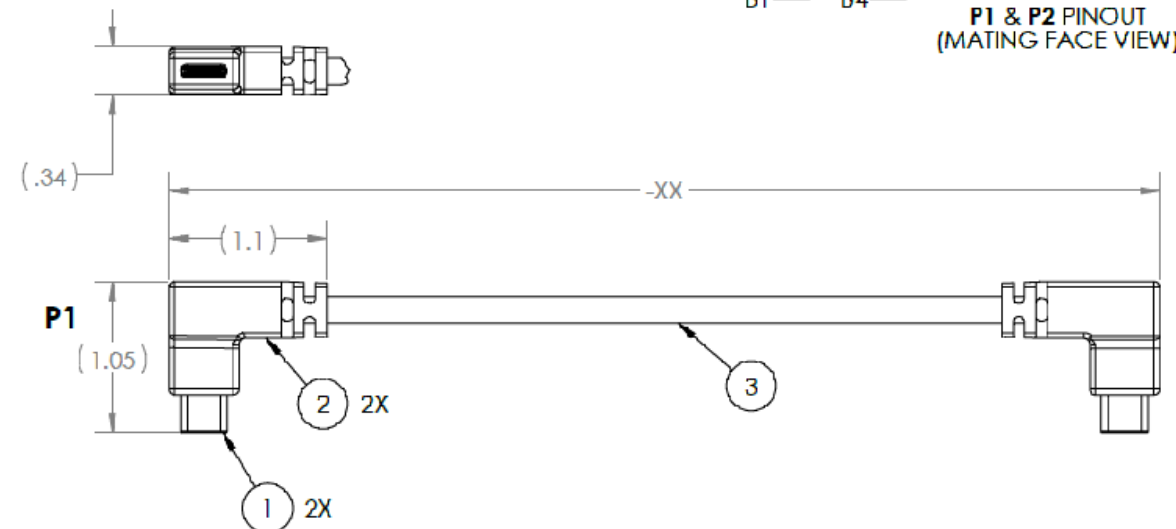
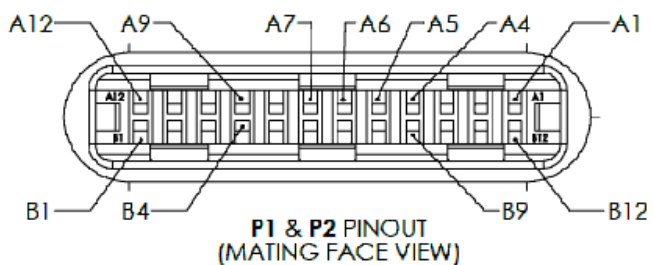
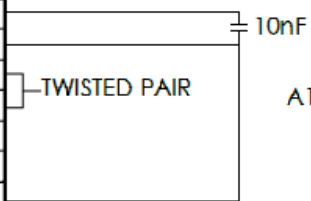

TABLE 2: CABLE LENGTH TABLE		
"-XX"	LENGTH (IN)	TOL
-01	42"	+/- 0.5
-03	90"	+/- 1.0
-06	156"	+/- 3.0

BILL OF MATERIALS			
ITEM NO.	PART NO.	QTY	NAME/DESCRIPTION
1	594 / or Equiv.	1	USB 3.1 TYPE C MALE WITH BREAKOUT PCB, ALL PINS AVAILABLE
2	SN-OM-2013	1	USB TYPE C OVER-MOLD
3	BN226422FEPSSIL	AR	USB CABLE: 22/28 AWG, 6C, SHIELDED, .185 DIA.

- NOTES:
1. WIRING SHALL BE DONE IN ACCORDANCE WITH TABLE 1 WIRE RUN LIST.
  2. SOLDERING: IAW IPC-J-STD-001 CLASS 2 AS APPLICABLE
  3. ASSEMBLY TO BE 100% TESTED FOR SHORTS, CONTINUITY, AND JACKET RESISTANCE (250V @ 100MOHM MIN.)
  4. IDENTIFICATION: BAG AND IDENTIFY ON THE PACKAGING THE FOLLOWING INFORMATION FOR EACH PART DELIVERED.  
PN: SN-2013-PD-XX REV. X (REV MARKING PER PO)  
CAGE CODE: 1HJX9  
MFD: MM/YY
  5. MANUFACTURE AND INSPECT IAW IPC/WHMA A-620 CLASS 2.

UNLESS OTHERWISE SPECIFIED:		NAME	DATE
DIMENSIONS ARE IN: INCHES		DRAWN	MOB 10/31/22
TOLERANCES: DEC: ± 0.005		CHECKED	RB 10/31/22
ANGULAR: .XX° ± 0.5°		COMMENTS:	
BREAK EDGES: .005 - .000		<u>PROPRIETARY AND CONFIDENTIAL</u> THE INFORMATION CONTAINED IN THIS DRAWING IS THE SOLE PROPERTY OF SUPPLYNET INC. ANY REPRODUCTION IN PART OR AS A WHOLE WITHOUT THE WRITTEN PERMISSION OF SUPPLYNET INC. IS PROHIBITED.	
FILLET: .005 - .000			
SURFACE FINISH:			
GEOMETRIC TOLERANCING PER: ASME Y14.5-2009			
MATERIAL: SEE DRAWING NOTES		CAGE CODE: 1HJX9	
FINISH: SEE DRAWING NOTES		DO NOT SCALE DRAWING	

REF. NUMBER: SN0938

**SupplyNet** 706 EXECUTIVE BLVD  
SUITE B VALLEY COTTAGE, NY 10989

TITLE: **CABLE, DOUBLE ENDED USB-C RT ANGLE, USB-C PD CAPABLE**

SIZE DWG. NO. REV  
**B SN-2013-PD-XX A**

SCALE: NA WEIGHT: SHEET 1 OF 1

PROPRIETARY AND CONFIDENTIAL  
THE INFORMATION CONTAINED IN THIS DRAWING IS THE SOLE PROPERTY OF SUPPLYNET, INC. ANY REPRODUCTION IN PART OR AS A WHOLE WITHOUT THE WRITTEN PERMISSION OF SUPPLYNET INC. IS PROHIBITED.

DO NOT SCALE DRAWING CAGE CODE: 1HJX9

REF. NUMBER: SN0938

**SupplyNet** 706 EXECUTIVE BLVD  
SUITE B VALLEY COTTAGE, NY 10989

TITLE: **CABLE, USB-C RT ANGLE, 9/16-24 THREADED SR, USB-C PD CAPABLE**

SIZE DWG. NO. REV  
**B SN-2013-PD-916-XX**

SCALE: NA WEIGHT: SHEET 2 OF 2