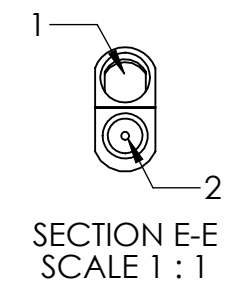
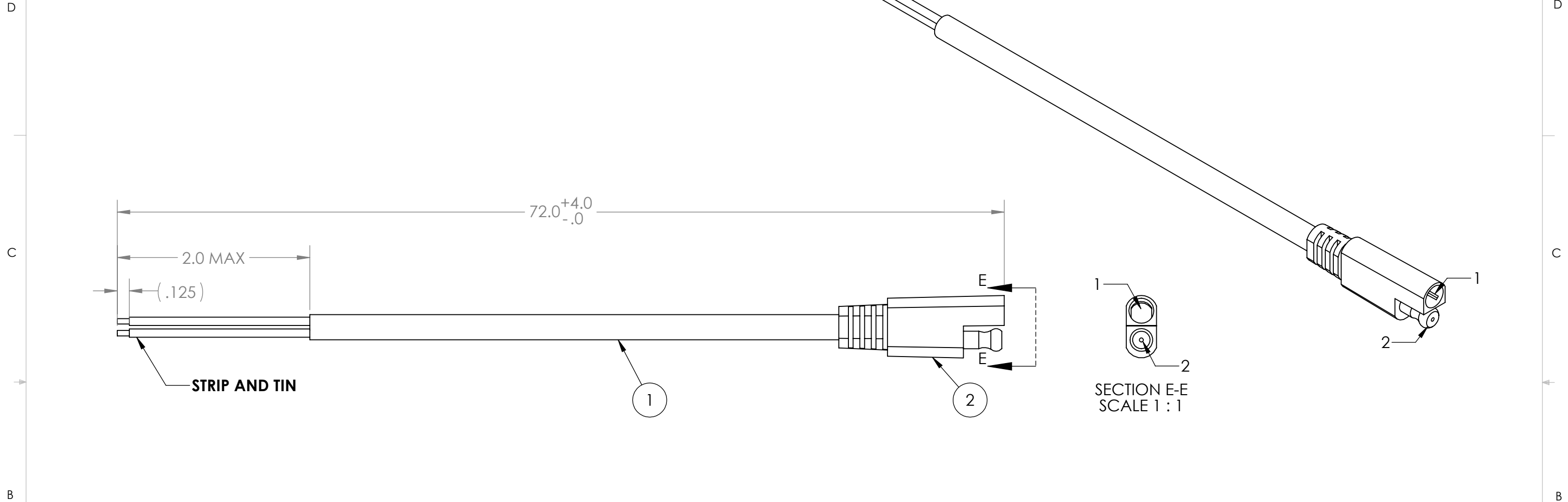

TABLE 1: WIRE RUN	
P1	WIRE COLOR
1 (COVERED)	RED
2 (UNCOVERED)	BLACK

REVISIONS			
REV.	DESCRIPTION	DATE	ENG
A	INITIAL RELEASE	5/01/2024	MOB



BILL OF MATERIALS				
ITEM NO.	PART NO.	QTY	NAME/DESCRIPTION	SUPPLIER CODE
1	164C-V02A	40'	CABLE, AWG 16, 4C, PVC JKT, .259 DIA.	SCS
2	YS31-0048	1	CONNECTOR, SAE 2 PIN	SCS

- NOTES:
1. WIRING SHALL BE DONE IN ACCORDANCE WITH TABLE 1 WIRE RUN LIST.
 2. PACKAGING REQUIREMENTS:
 - A. COMPLETED ASSEMBLIES MAY BE BULK PACKAGED.
 - B. PACKAGE SHALL BE MARKED WITH SUPPLYNET LOGO, PART NO., CAGE CODE, LOT NO., & PART NO. QR CODE PER SN-STD-LBL REQUIREMENTS.
 3. WORKMANSHIP REQUIREMENTS:
 - A. MANUFACTURE TO IAW/WHMA A-620 CLASS 2 REQUIREMENTS.
 - B. SOLDERING SHALL BE COMPLIANT WITH IAW J-STD-001 AS APPLICABLE.
 - C. CONNECTOR SHALL BE FREE FROM ANY SCRATCHES, CHIPS, AND DEFECTS.
 4. INSPECTION REQUIREMENTS:
 - A. EACH COMPLETED ASSEMBLY TO BE 100% TESTED FOR SHORTS, CONTINUITY, AND JACKET RESISTANCE, (250V @ 100MOHM MIN.)
 - B. INSPECT TO IPC/WHMA A-620 CLASS 2 REQUIREMENTS.

SUPPLIER CODE KEY	
CODE	MEANING
SCS	SUB-CONTRACTOR SOURCED & SUPPLIED
SN	SUPPLYNET SOURCED & SUPPLIED
-L	LONG LEAD TIME ITEM

UNLESS OTHERWISE SPECIFIED:
 DIMENSIONS ARE IN: INCHES
 TOLERANCES: .XX: ± 0.03
 .XXX: ± 0.005
 ANGULAR: .X°: 1°
 .XX°: 0.5°
 BREAK EDGES: .005 - .020
 FILLETS: .005 - .020
 SURFACE FINISH:
 GEOMETRIC TOLERANCING PER: ASME Y14.5 -2009
 MATERIAL: SEE DRAWING NOTES
 FINISH: SEE DRAWING NOTES
 DO NOT SCALE DRAWING

	NAME	DATE
DRAWN	MOB	5/1/2024
CHECKED	RB	5/1/2024
COMMENTS:		

REF. NUMBER: SN1172

SupplyNet DESIGN ENGINEERING MANUFACTURING

TITLE: **CABLE SUB ASSEMBLY, SAE CONNECTOR PIGTAIL CABLE, 6FT.**

SIZE B	DWG. NO. SN-210-SAE-SUB	REV A
SCALE: NA	WEIGHT:	SHEET 1 OF 1

CAGE CODE: 1HJX9