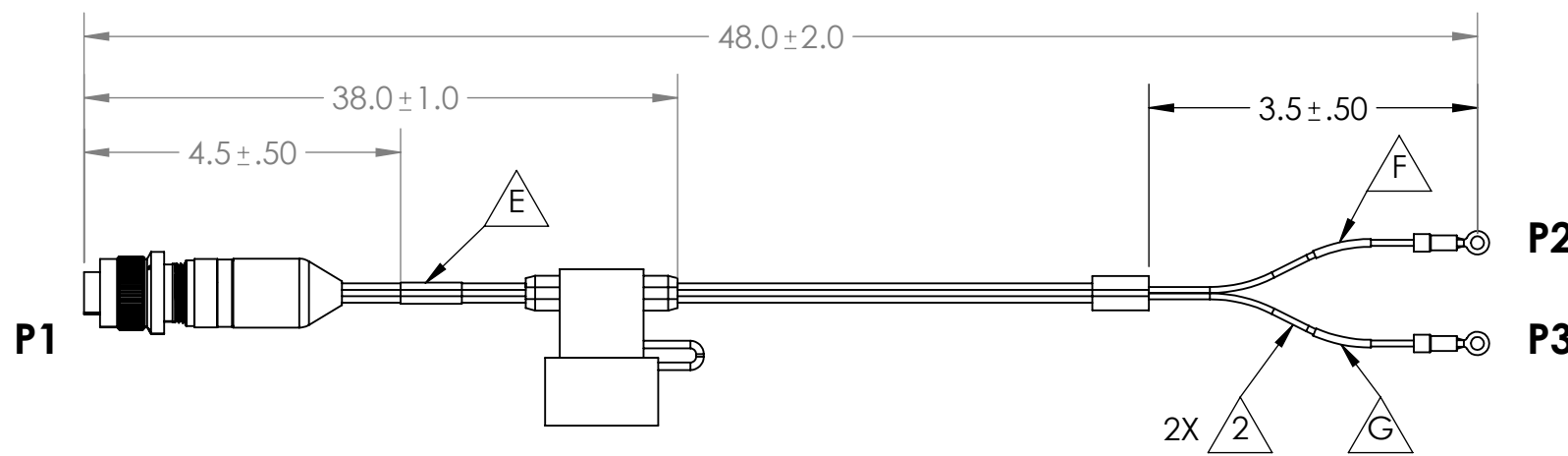
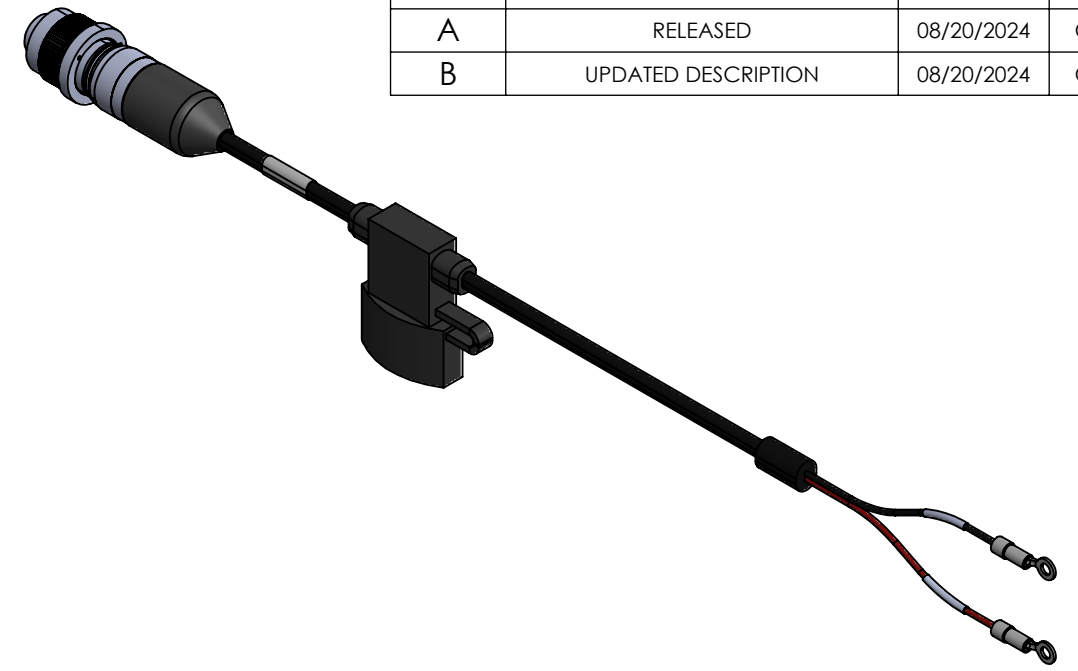
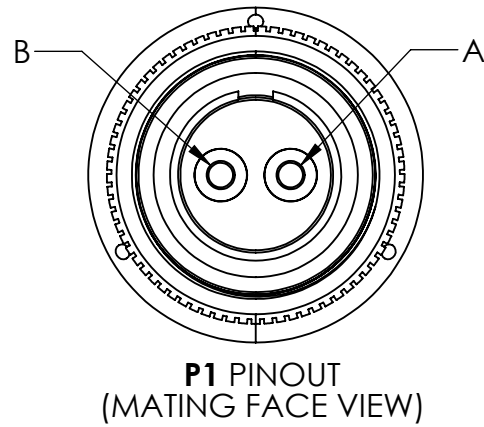

TABLE 1: WIRE RUN		
P1	WIRE COLOR	RING TERMINALS
A	RED(FUSE)	P3
B	BLACK	P2

REVISIONS			
REV.	DESCRIPTION	DATE	ENG
A	RELEASED	08/20/2024	CWA
B	UPDATED DESCRIPTION	08/20/2024	CWA



NOTES:

- WIRING SHALL BE DONE IN ACCORDANCE WITH TABLE 1 WIRE RUN LIST.
- STRIP JACKET 3.5 INCHES AND STRIP CONDUCTORS .197 INCHES.
- MARKING REQUIREMENTS:
 - A. LABELS SHALL BE MARKED IN ACCORDANCE WITH MIL-STD-130 AS APPLICABLE.
 - B. LABELS SHALL BE WHITE WITH BLACK TEXT.
 - C. LABELS SHALL BE PLACED WHERE SHOWN IN DRAWING.
 - D. ADHESIVE WRAP AROUND LABEL MAY BE USED.
 - E. LABEL SHALL BE MARKED WITH THE BELOW INFORMATION ONLY. (REV MARKING PER PO)
PN: SN-987-5019-C2 REV. X
CAGE: 1HJX9
MFD: MM/YY
 - F. LABEL SHALL BE MARKED WITH: - - - - -
 - G. LABEL SHALL BE MARKED WITH: + + + + +
- PACKAGING REQUIREMENTS:
 - A. EACH COMPLETED ASSEMBLY SHALL BE PACKAGED IN A ZIP POLYBAG.
 - B. CONNECTOR(S) SHALL BE PACKAGED TO PREVENT DAMAGE DURING SHIPPING. BUBBLE WRAP OR PROTECTIVE COVER MUST BE USED.
 - C. POLYBAG SHALL BE MARKED WITH SUPPLYNET LOGO, PRODUCT QR CODE, PART NUMBER, CAGE CODE, AND LOT NO, PER SN-STD-LBL REQUIREMENTS.
- WORKMANSHIP REQUIREMENTS:
 - A. MANUFACTURE TO IAW/WHMA A-620 CLASS 2 REQUIREMENTS.
 - B. SOLDERING SHALL BE COMPLIANT WITH IAW J-STD-001 AS APPLICABLE.
 - C. CONNECTOR(S) AND WIRE SHALL BE FREE FROM ANY SCRATCHES, CHIPS, AND DEFECTS.
- INSPECTION REQUIREMENTS:
 - A. EACH COMPLETED ASSEMBLY TO BE 100% TESTED FOR SHORTS, CONTINUITY, AND JACKET RESISTANCE (250V @100MOHM MIN.)
 - B. INSPECT TO IPC/WHMA A-620 CLASS 2 REQUIREMENTS.

UNLESS OTHERWISE SPECIFIED:		NAME	DATE	REF. NUMBER: SN0629
DIMENSIONS ARE IN: INCHES TOLERANCES: .XX: ± 0.03 .XXX: ± 0.005 ANGULAR: .X°: 1° .XX°: 0.5° BREAK EDGES: .005 - .020 FILLETS: .005 - .020 SURFACE FINISH:		DRAWN	MOB 3/31/2023	
GEOMETRIC TOLERANCING PER: ASME Y14.5 -2009		CHECKED	MOB 3/31/2023	
MATERIAL: SEE DRAWING NOTES FINISH: SEE DRAWING NOTES		COMMENTS:		
DO NOT SCALE DRAWING		PROPRIETARY AND CONFIDENTIAL THE INFORMATION CONTAINED IN THIS DRAWING IS THE SOLE PROPERTY OF SUPPLYNET, INC. ANY REPRODUCTION IN PART OR AS A WHOLE WITHOUT THE WRITTEN PERMISSION OF SUPPLYNET INC. IS PROHIBITED.		TITLE: <h2>MSAS 5 Amp Power Cable</h2>
		CAGE CODE: 1HJX9		
SIZE	DWG. NO.	REV		
B	SN-987-5019-C2	B		
SCALE: NA	WEIGHT:	SHEET 1 OF 1		